



RF Components

Model Number:
WGLA-0005-197142

Ku-Band Waveguide Load

18 - 26.50 GHz

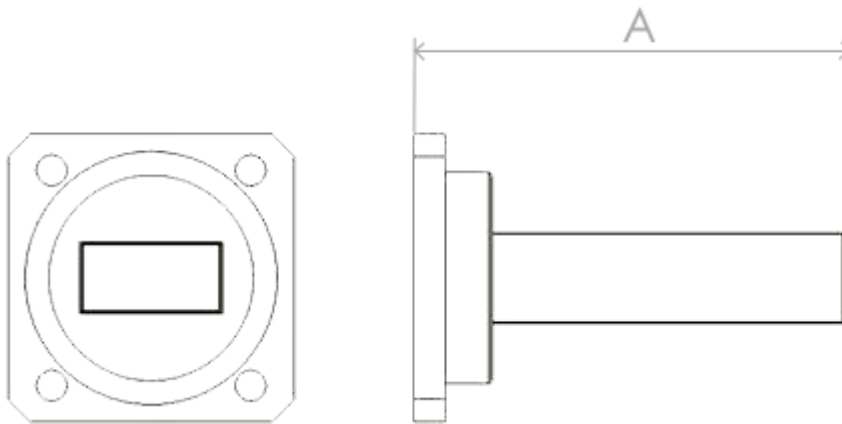

Specification	
Waveguide Size	WG20 / WR42 / R220
Flanges	UG 596A/U (UG) / UG595/U (UF) CBR 220 (CB) / PBR 220 (PB) UBR 220 (UB) / UG595/U (US)
Flange Material/Finish	Aluminium
Frequency Range	18 - 26.50 GHz
Length (A)	100 mm
VSWR / Return Loss	1.035:1 / 36.6 dB
Power Handling	5W

Model Numbers Example WGLA-0005-197142-PB				
WGL	A	0005	197142	UB
Waveguide Load / Termination	A—Aluminium B— Brass	Power Handling (W)	Model Number	Waveguide Flange

Broadcast



Marine Oil & Gas



SNG & VSAT



Satellite Teleport

